

CABLE TROLLEYS, LONG TROLLEY

Acid proof, Stainless steel for C-rail 30x32 mm

Flat cable



Sheet 11-33S 2016

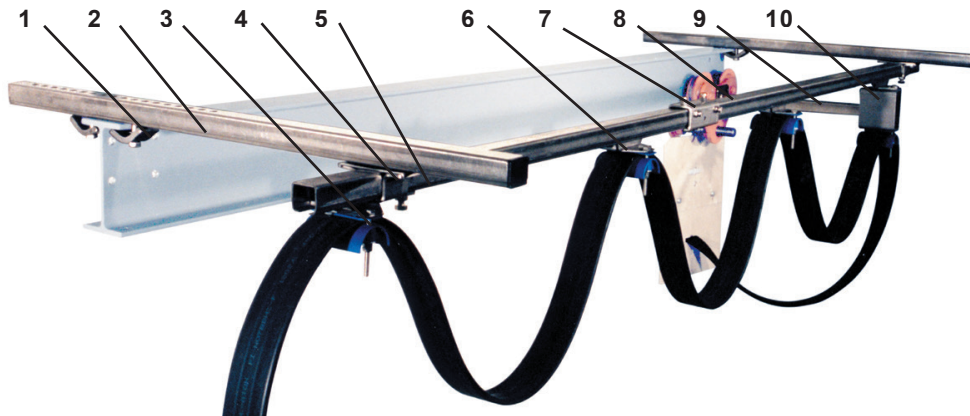

1. Girder clips
2. Support arm
3. End clamp
4. Support bracket
5. End stop
6. Cable trolley
7. Track coupler
8. C-rail
9. Towing arm
10. Towing trolley

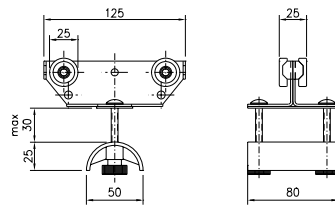

Cable trolley flatcable

Material: Acid proof steel SS 2343 (body)
Stainless & dust-proof bearings
Polyamide (cable clamp)
Acid proof steel A4 (Nuts & bolts)

Cable load, kg: 20
Weight, kg: 0,36
L, mm: 125
S, mm: 35
Article No.: 11 315

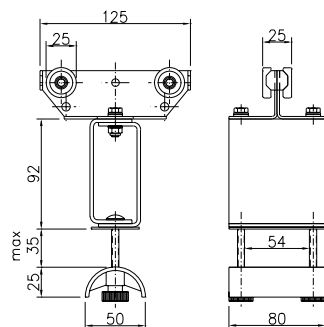

Towing trolley flatcable

Material: Acid proof steel SS 2343 (body)
Stainless & dust-proof bearings
Polyamide (cable clamp)
Acid proof steel A4 (Nuts & bolts)

Cable load, kg: 20
Weight, kg: 0,6
Article No.: 11 769

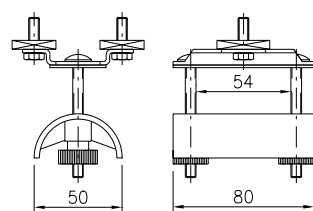
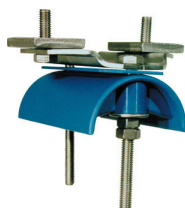

End clamp flatcable

Material: Acid proof steel SS 2343 (body)
Polyamide (cable clamp)
Acid proof steel A4 (Nuts & bolts)

Weight, kg: 0,2
Article No.: 11 782

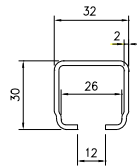

C-rail

Material: Acid proof steel SS2343
 Length, mm: 4000 6000
 Weight, kg: 6,2 9,3
 Article No.: **11 899** **11 799**

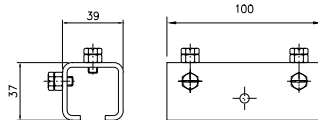

Track coupler

Material: Acid proof steel SS2343
 Weight, kg: 0,28
 Article No.: **11 809**

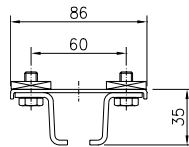

Support bracket with square nuts

Material: Acid proof steel SS2343
 Weight, kg: 0,24
 Article No.: **11 819**

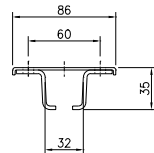

Support bracket for ceiling mounting

Material: Acid proof steel SS2343
 Weight, kg: 0,16
 Article No.: **11 826**

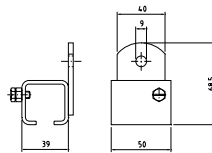

Support bracket for wall mounting

Material: Acid proof steel SS2343
 Weight, kg: 0,20
 Article No.: **11 836**

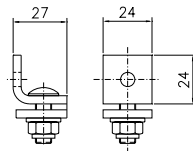

End stop

Material: Acid proof steel SS2343
 Weight, kg: 0,13
 Article No.: **11 840**

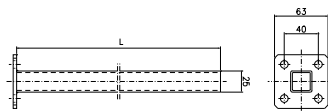

Towing arm

Material: Acid proof steel SS2343
 Length, mm: 400
 Weight, kg: 0,6
 Article No.: **11 706**

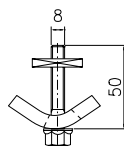

Girder clips (two for each support arm)

Material: Acid proof steel SS2343
 Weight, kg: 0,15
 Article No.: **11 738**

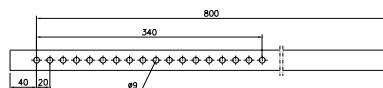

Support arm

Material: Acid proof steel SS2343
 Length, mm: 800
 Weight, kg: 1,25
 Article No.: **11 722**